

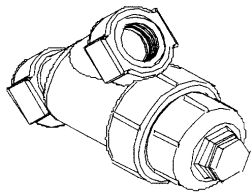

**SUCTION LINE STRAINERS**  
 MOLDED PVC BASE  
 ST. STEEL SCREENS

<i>Fpt</i>	<i>Mesh</i>	<i>Part #</i>	<i>List/E</i>
1/4	20	RV663-20	4.90
1/4	40	RV663	4.90
1/4	80	RV663-80	4.90
1/4	100	RV663-100	4.90
3/8	40	RV6631	5.40
3/8	80	RV6631-80	5.40
1/2	40	RV6632	6.45
1/2	80	RV6632-80	6.45
3/4	40	RV6633	7.05
1	40	RV6634	10.25
1 1/2	40	RV6636	12.10



**Y STRAINERS**  
 POLYPROPYLENE BODY  
 EPDM GASKET  
 (VITON AVAILABLE)  
 ST. STEEL SCREENS  
 FPT THREADS

<i>Fpt</i>	<i>Part #</i>	<i>List/E</i>
1/2	YST88PE_P	45.45
3/4	YST1212PE_P	45.45
1	YST1616PE_P	47.52
1 1/4	YST2020PE_P	47.52
1 1/2	YST2424PE_P	99.99
2	YST3232PE_P	99.99
3	YST4848PE_P	666.57

Please specify screen when ordering. See parts list below for sizes.

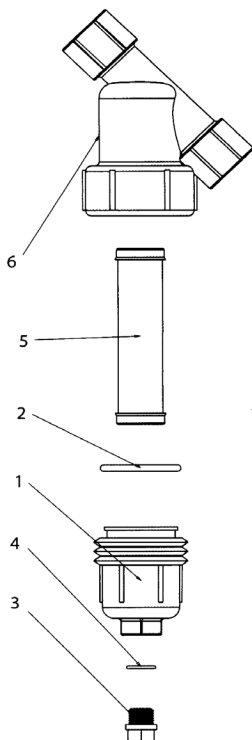

**Y STRAINER PARTS**

COMPONENT(1,2,6)		SIZE	PART #		LIST/E	
BODY, CAP & EPDM GASKET		1/2	YST88-B/C		20.71	
BODY, CAP & EPDM GASKET		3/4	YST1212-B/C		20.71	
BODY, CAP & EPDM GASKET		1	YST1616-B/C		20.71	
BODY, CAP & EPDM GASKET		1 1/4	YST2020-B/C		20.71	
BODY, CAP & EPDM GASKET		1 1/2	YST2424-B/C		49.28	
BODY, CAP & EPDM GASKET		2	YST3232-B/C		49.28	
BODY, CAP & EPDM GASKET		3	YST4848-B/C		506.05	
COMPONENT(2) MATERIAL		SIZE	PART #		LIST/E	
GASKET	VITON	1/2 & 3/4	YST88-GV		6.23	
GASKET	VITON	1 & 1 1/4	YST1616-GV		8.17	
GASKET	VITON	1 1/2 & 2	YST2424-GV		13.74	
GASKET	VITON	3	YST4848-GV		46.72	
COMPONENT(S) MAT	SIZE	MESH	MICRON	PART #	LIST/E	
SCREEN	ST STEEL	1/2 & 3/4	20	841	YST88-20	24.34
SCREEN	"	"	40	446	YST88-40	24.34
SCREEN	"	"	80	177	YST88-80	24.34
SCREEN	ST STEEL	1 & 1 1/4	20	841	YST1616-20	24.34
SCREEN	"	"	40	446	YST1616-40	24.34
SCREEN	"	"	80	177	YST1616-80	24.34
SCREEN	ST STEEL	1 1/2 & 2	6	3360	YST3232-6	50.28
SCREEN	"	"	8	2380	YST3232-8	50.28
SCREEN	"	"	12	1680	YST3232-12	50.28
SCREEN	"	"	20	841	YST3232-20	50.28
SCREEN	"	"	30	595	YST3232-30	50.28
SCREEN	"	"	50	297	YST3232-50	50.28
SCREEN	"	"	80	177	YST3232-80	50.28
SCREEN	"	"	120	116	YST3232-120	50.28
SCREEN	POLYPRO	"	20	841	YST3232-20P	50.28
SCREEN	POLYPRO	"	50	297	YST3232-50P	50.28
SCREEN	ST STEEL	3	4		YST4848-4	156.05
SCREEN	"	"	8	2380	YST4848-8	156.05
SCREEN	"	"	12	1680	YST4848-12	156.05
SCREEN	"	"	20	841	YST4848-20	156.05
SCREEN	"	"	50	297	YST4848-50	156.05